

Installation Instructions

1. Ensure the faces of the aperture opening are free of dust and any other contaminants. The faces may be moistened for better adhesion.
2. Bare metal passing through the seal must be protected against corrosion using a suitable primer/protection system.
3. The seal can be positioned to either side of the construction or anywhere in between.
4. When installing Protecta® EX Mortar in hollow floor slabs or boards, level the fire seal with the soffit side. Ensure there is sufficient thickness of concrete below the void for the depth of mortar. Where this is not the case, tubular voids should be filled with stone wool normally the same thickness as the depth of the floor slab. Alternatively, simply fire seal on both sides.
5. Install a stone wool shutter board to achieve the required thickness of mortar. Make sure that this achieves a very tight seal – any small openings should be sealed with Protecta® FR Acrylic
6. Pour clean water into a suitable mixing vessel and pour enough mortar to obtain the required consistency. Mix well to avoid lumps. Always add the mortar to the water, do not reverse this mixing process.
7. Once the desired consistency is achieved pour or trowel the mortar onto the shutter board making sure that it flows into all corners and around services. Apply a firm pressure to the mortar to eliminate any trapped air bubbles. Build up to the required depth.

MIXED SERVICE APERTURE - EX MORTAR 50mm - CONCRETE FLOOR

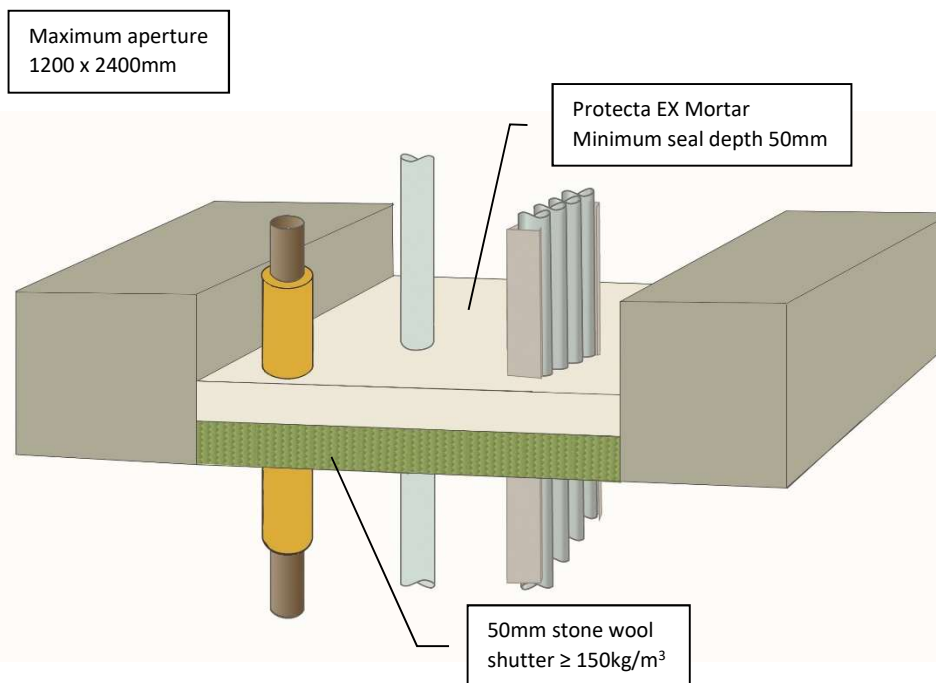

Minimum separations and limitations

An aperture can include several services, and they may also be different. The minimum permitted separation between adjacent seals/apertures is 200mm. Services should be a minimum of 30mm from seal edges. Services within the seal do not require a minimum separation, except pipes where combustible pipe insulation penetrates the seal and plastic pipe penetrations which should be a minimum of 30mm from other services in the aperture. The total amount of cross sections of services (including insulation) should not exceed 60% of the penetration area.

For Fire Classifications refer to relevant systems in this website

| | |
|---------------------|---------------------------------------------------------------------------------------------------------------------------|
| Products | Protecta EX Mortar Stone wool shutter |
| Construction | Minimum floor thickness of 100mm and comprise aerated concrete or concrete with a minimum density of 650kg/m ³ |

Services

1. Cables ≤ Ø21mm, single or bundled, non-sheathed cables/wires ≤ Ø17mm and PVC conduits ≤ Ø16mm, with or without cable trays
2. Steel pipes ≤ Ø16mm (C/U)
3. Steel pipes ≤ Ø324mm with 20-80mm thick continuous stone wool insulation
4. Steel pipes ≤ Ø40mm with ≥ 20mm thick interrupted stone wool insulation
5. Steel pipes ≤ Ø219mm with ≥ 30mm thick interrupted stone wool insulation
6. Copper pipes Ø6mm
7. Copper pipes ≤ Ø54mm with 20-80mm thick continuous stone wool insulation
8. Copper pipes ≤ Ø54mm with ≥ 20mm thick interrupted stone wool insulation
9. Alupex pipes ≤ Ø20mm
10. Alupex pipes ≤ Ø75mm with ≥ 20mm thick interrupted stone wool insulation
11. PVC-U & PVC-C pipes ≤ Ø40mm
12. PEX pipe-in-pipes ≤ Ø25mm



As a part of our policy of on-going product development and testing, we reserve the right to modify, alter or change product specifications without giving notice. All information contained in this document is given in good faith and is provided for guidance only. Any drawings provided are for illustrative purposes only. As Polyseam has no control over the methods or competence of installation and of prevailing site conditions, no warranties, expressed or implied, is intended to be given as to the actual performance of the product mentioned or referred to herein and no liability whatsoever will be accepted for any loss, damage or injury arising from the use of the information given.

For all technical details on the products specified please refer to the technical data sheets that can be found on <http://www.protecta.eu>

Polyseam Ltd, 15 St Andrews Road, Huddersfield, West Yorkshire, HD1 6SB, United Kingdom
Tel: +44 (0) 1484 421 036

Scale:
NTS

Drawn by & date:
K.B. 23/5/21